

EL 系列
SERIES

85°C 長壽命品 5000 小時
壽命：85°C 5000 小時

85°C LONG LIFE 5000 hrs
Load Life :85°C 5000 hours

■ 規格表 SPECIFICATIONS

項目 Items	特性 Characteristics								
使用溫度範圍 Category Temperature Range	-25~+85°C								
額定電壓範圍 Rated Voltage Range	160~450V.DC								
靜電容量容許差 Capacitance Tolerance	±20%(M)(25°C, 120Hz)								
洩漏電流 Leakage Current (MAX)	I ≤ 0.03CV (施加額定電壓 5 分鐘後) (After 5 minutes application of rated voltage)								
	I : 洩漏電流 Leakage Current(μA) C : 額定靜電容量 Rated Capacitance(μF) V : 額定電壓 Rated Voltage(V)								
散逸因素(tan δ) Dissipation Factor (MAX)	額定電壓(V) Rated Voltage	160	200	250	350	400	450	120Hz	
	tan δ	0.20	0.20	0.20	0.25	0.25	0.25	25°C	
高溫負荷 Load Life	85°C 恆溫施加額定電壓(含紋波電流)5000 小時後，必須滿足下列的值。 After applying rated voltage with rated ripple current for 5000hrs at 85°C, the capacitors shall meet the following requirements								
	靜電容量變化率 Capacitance Change	初期值±25%以內						Within ±25% of the initial value	
	散逸因素(tan δ) Dissipation Factor	規格值 150%以下						Not more than 150% of the specified value	
	洩漏電流 Leakage Current	規格值以下						Not more than the specified value	
高溫放置 Shelf Life	85°C 恆溫不施加額定電壓 1000 小時後，必須滿足下列的值。 After applying no rated voltage for 1000hrs at 85°C. The capacitors shall meet the following requirements.								
	靜電容量變化率 Capacitance Change	初期值±20%以內						Within ±20% of the initial value	
	散逸因素(tan δ) Dissipation Factor	規格值 150%以下						Not more than 150% of the specified value	
	洩漏電流 Leakage Current	規格值 150%以下						Not more than 150% of the specified value	
突波電壓(V) Surge Voltage	額定電壓(V) Rated Voltage	160	200	250	350	400	450		
	突波電壓(V) Surge Voltage	200	250	300	400	450	500		
低溫特性 Low Temperature Stability (合成阻抗比) Impedance Ratio (MAX)	額定電壓(V) Rated Voltage	160	200	250	350	400	450	120Hz	
	Z(-25°C) / Z(25°C)	6	6	6	8	8	8		

■ 尺寸圖 DIMENSIONS

(mm)

■ 紋波電流補償係數 MULTIPLIER FOR RIPPLE CURRENT

(1) 頻率係數 Frequency coefficient

頻率(Hz) Frequency		60	120	1k	10k	100k
係數 Coefficient	160~250V	0.80	1.00	1.35	1.45	1.50
	315~450V	0.80	1.00	1.10	1.15	1.20

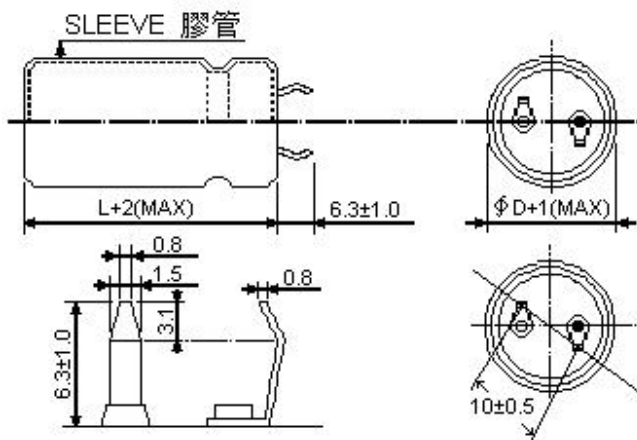

■ 尺寸一覽表，額定紋波電流一覽表 STANDARD SIZE, RATED RIPPLE CURRENT

Size ϕ D \times L(mm), Ripple Current (A r.m.s./85°C, 120 Hz)

額定電壓 WV(V.DC)	160 (2C)								額定電壓 WV(V.DC)	200 (2D)							
	ϕ 22		ϕ 25		ϕ 30		ϕ 35			ϕ 22		ϕ 25		ϕ 30		ϕ 35	
	Size	Ripple	Size	Ripple	Size	Ripple	Size	Ripple		Size	Ripple	Size	Ripple	Size	Ripple	Size	Ripple
330	22 \times 25	0.90							270	22 \times 25	0.80						
390	22 \times 30	1.10							330	22 \times 30	1.05						
470	22 \times 35	1.30	25 \times 25	1.10					390	22 \times 35	1.25	25 \times 25	1.05				
560	22 \times 40	1.50	25 \times 30	1.50					470	22 \times 40	1.45	25 \times 30	1.45				
680	22 \times 45	1.70	25 \times 35	1.70	30 \times 25	1.50			560	22 \times 45	1.65	25 \times 35	1.65	30 \times 25	1.45		
820	22 \times 50	2.00	25 \times 40	2.00	30 \times 30	2.00	35 \times 25	2.00	680	22 \times 50	1.90	25 \times 40	1.90	30 \times 30	1.90	35 \times 25	1.90
1000			25 \times 45	2.25	30 \times 35	2.25	35 \times 30	2.60	820			25 \times 45	2.20	30 \times 35	2.20	35 \times 30	2.50
1200			25 \times 50	2.60	30 \times 40	2.60	35 \times 35	3.00	1000			25 \times 50	2.50	30 \times 40	2.50	35 \times 35	2.90
1500					30 \times 45	3.00	35 \times 40	3.40	1200					30 \times 45	2.90	35 \times 40	3.30
1800					30 \times 50	3.40	35 \times 45	3.70	1500					30 \times 50	3.30	35 \times 45	3.60
2200							35 \times 50	4.10	1800							35 \times 50	4.00

額定電壓 WV(V.DC)	250 (2E)								額定電壓 WV(V.DC)	350 (2V)							
	ϕ 22		ϕ 25		ϕ 30		ϕ 35			ϕ 22		ϕ 25		ϕ 30		ϕ 35	
	Size	Ripple	Size	Ripple	Size	Ripple	Size	Ripple		Size	Ripple	Size	Ripple	Size	Ripple	Size	Ripple
180	22 \times 25	0.70							100	22 \times 25	0.50						
220	22 \times 30	0.90							120	22 \times 30	0.60						
270	22 \times 35	1.05							150	22 \times 35	0.00	25 \times 25	0.70				
330	22 \times 40	1.20	25 \times 30	1.20					180	22 \times 40	0.80	25 \times 30	0.80				
390	22 \times 45	1.40	25 \times 35	1.40	30 \times 25	1.20			220	22 \times 45	0.95	25 \times 35	0.95	30 \times 25	0.95		
470	22 \times 50	1.60	25 \times 40	1.60	30 \times 30	1.60	35 \times 25	1.60	270	22 \times 50	1.10	25 \times 40	1.10	30 \times 30	1.10	35 \times 25	1.10
560			25 \times 45	1.90	30 \times 35	1.90	35 \times 30	2.10	330			25 \times 45	1.25	30 \times 35	1.25	35 \times 30	1.40
680			25 \times 50	2.10	30 \times 40	2.10	35 \times 35	2.40	390			25 \times 50	1.40	30 \times 40	1.40	35 \times 35	1.65
820					30 \times 45	2.40	35 \times 40	2.80	470					30 \times 45	1.65	35 \times 40	1.90
1000					30 \times 50	2.80	35 \times 45	3.30	560					30 \times 50	1.90	35 \times 45	2.00
1200							35 \times 50	3.50	680							35 \times 50	2.50

額定電壓 WV(V.DC)	400 (2G)								額定電壓 WV(V.DC)	450 (2W)							
	ϕ 22		ϕ 25		ϕ 30		ϕ 35			ϕ 22		ϕ 25		ϕ 30		ϕ 35	
	Size	Ripple	Size	Ripple	Size	Ripple	Size	Ripple		Size	Ripple	Size	Ripple	Size	Ripple	Size	Ripple
100	22 \times 25	0.45							68	22 \times 25	0.40						
120	22 \times 30	0.60	25 \times 25	0.60					82	22 \times 30	0.55						
150	22 \times 35	0.70	25 \times 30	0.80					100	22 \times 35	0.60	25 \times 25	0.55				
180	22 \times 40	0.80	25 \times 35	0.95	30 \times 25	0.80			120	22 \times 40	0.70	25 \times 30	0.70				
220	22 \times 45	0.95	25 \times 40	1.05	30 \times 30	0.95			150	22 \times 45	0.00	25 \times 35	0.75	30 \times 25	0.75		
270	22 \times 50	1.05	25 \times 45	1.20	30 \times 35	1.20	35 \times 25	1.05	180	22 \times 50	0.90	25 \times 40	0.90	30 \times 30	0.90		
330			25 \times 50	1.40	30 \times 40	1.40	35 \times 30	1.40	220			25 \times 45	1.00	30 \times 35	1.00	35 \times 25	0.90
390					30 \times 45	1.60	35 \times 35	1.60	270			25 \times 50	1.15	30 \times 40	1.15	35 \times 30	1.15
470					30 \times 50	1.85	35 \times 40	1.85	330					30 \times 45	1.40	35 \times 35	1.40
560							35 \times 45	2.00	390					30 \times 50	1.60	35 \times 40	1.60
680							35 \times 50	2.50	470							35 \times 45	1.80
									560							35 \times 50	2.10