

BL 系列
SERIES

105°C 長壽命品 10000 小時
壽命：105°C 10000 小時

105°C LONG LIFE 10000 hrs
Load Life :105°C 10000 hours

■ 規格表 SPECIFICATIONS

| 項目 Items | 特性 Characteristics | | | | | | | | |
|---|---|------------|------|------|------|------|------|---|--|
| 使用溫度範圍 Category Temperature Range | -25~+105°C | | | | | | | | |
| 額定電壓範圍 Rated Voltage Range | 160~450V.DC | | | | | | | | |
| 靜電容量容許差 Capacitance Tolerance | ±20%(M)(25°C, 120Hz) | | | | | | | | |
| 洩漏電流 Leakage Current (MAX) | I ≤ 0.03CV + 40 μA (施加額定電壓 5 分鐘後) I ≤ 0.03CV + 40 μA (After 5 minutes application of rated voltage) | | | | | | | | |
| | I : 洩漏電流 Leakage Current(μA) C : 額定靜電容量 Rated Capacitance(μF) V : 額定電壓 Rated Voltage(V) | | | | | | | | |
| 散逸因素(tan δ) Dissipation Factor (MAX) | 額定電壓(V) Rated Voltage | 160 | 200 | 250 | 350 | 400 | 450 | 25°C 120Hz | |
| | tan δ | 0.15 | 0.15 | 0.15 | 0.20 | 0.20 | 0.20 | | |
| 高溫負荷 Load Life | 105°C 恆溫施加額定電壓(含紋波電流)10000 小時後，必須滿足下列的值。 After applying rated voltage with rated ripple current for 10000hrs at 105°C, the capacitors shall meet the following requirements. | | | | | | | | |
| | 靜電容量變化率 Capacitance Change | 初期值±25%以內 | | | | | | Within ±25% of the initial value | |
| | 散逸因素(tan δ) Dissipation Factor | 規格值 200%以下 | | | | | | Not more than 200% of the specified value | |
| | 洩漏電流 Leakage Current | 規格值以下 | | | | | | Not more than the specified value | |
| 高溫放置 Shelf Life | 105°C 恆溫不施加額定電壓 1000 小時後，必須滿足下列的值。 After applying no rated voltage for 1000hrs at 105°C. The capacitors shall meet the following requirements. | | | | | | | | |
| | 靜電容量變化率 Capacitance Change | 初期值±20%以內 | | | | | | Within ±20% of the initial value | |
| | 散逸因素(tan δ) Dissipation Factor | 規格值 200%以下 | | | | | | Not more than 200% of the specified value | |
| | 洩漏電流 Leakage Current | 規格值 200%以下 | | | | | | Not more than 200% of the specified value | |
| 突波電壓(V) Surge Voltage | 額定電壓(V) Rated Voltage | 160 | 200 | 250 | 350 | 400 | 450 | | |
| | 突波電壓(V) Surge Voltage | 200 | 250 | 300 | 400 | 450 | 500 | | |
| 低溫特性 Low Temperature Stability (合成阻抗比) Impedance Ratio (MAX) | 額定電壓(V) Rated Voltage | 160 | 200 | 250 | 350 | 400 | 450 | 120Hz | |
| | Z(-25°C) / Z(25°C) | 4 | 4 | 4 | 8 | 8 | 15 | | |

■ 尺寸圖 DIMENSIONS

(mm)

■ 紋波電流補償係數 MULTIPLIER FOR RIPPLE CURRENT

(1) 頻率係數 Frequency coefficient

| 頻率(Hz) Frequency | | 60(50) | 120 | 1k | ≥10k |
|---------------------|-----------|--------|------|------|------|
| 係數 Coefficient | 160~250WV | 0.80 | 1.00 | 1.15 | 1.20 |
| | 350~450WV | 0.80 | 1.00 | 1.30 | 1.50 |

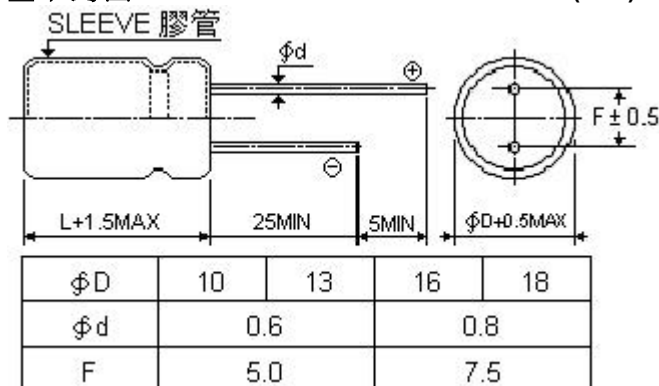

■ 尺寸一覽表，額定紋波電流一覽表 STANDARD SIZE, RATED RIPPLE CURRENT

Size ϕ D×L(mm), Ripple Current (mA r.m.s./105°C,120Hz)

| 額定電壓 WV(V.DC) | 160 (2C) | | 額定電壓 WV(V.DC) | 200 (2D) | | 額定電壓 WV(V.DC) | 250 (2E) | |
|------------------|-------------|--------|------------------|-------------|--------|------------------|-------------|--------|
| | Size | Ripple | | Size | Ripple | | Size | Ripple |
| 22 | 10×13 | 170 | 15 | 10×13 | 140 | 10 | 10×13 | 120 |
| 33 | 10×16 | 220 | 27 | 10×16 | 210 | 18 | 10×16 | 180 |
| 47 | 10×21 | 300 | 39 | 10×21 | 290 | 22 | 10×21 | 230 |
| 56 | 10×25 | 360 | 47 | 10×25 | 340 | 27 | 10×25 | 270 |
| 100 | 13×21 | 510 | 68 | 13×21 | 440 | 47 | 13×21 | 390 |
| 120 | 13×26 | 620 | 82 | 13×26 | 540 | 56 | 13×26 | 470 |
| 150 | 13×31 | 750 | 100 | 16×21 | 610 | 68 | 13×31 | 560 |
| 180 | 16×24 | 820 | 120 | 16×24 | 700 | 82 | 16×24 | 610 |
| 270 | 16×32 | 1150 | 180 | 16×32 | 980 | 120 | 16×32 | 840 |
| 330 | 16×36 | 1340 | 220 | 16×36 | 1140 | 150 | 16×36 | 1000 |
| 390 | 18×36 | 1550 | 270 | 18×36 | 1350 | 180 | 18×36 | 1160 |
| 470 | 18×41 | 1810 | 330 | 18×41 | 1590 | 220 | 18×41 | 1370 |

| 額定電壓 WV(V.DC) | 350 (2V) | | 額定電壓 WV(V.DC) | 400 (2G) | | 額定電壓 WV(V.DC) | 450 (2W) | |
|------------------|-------------|--------|------------------|-------------|--------|------------------|-------------|--------|
| | Size | Ripple | | Size | Ripple | | Size | Ripple |
| 6.8 | 10×13 | 90 | 5.6 | 10×13 | 80 | 4.7 | 10×13 | 70 |
| 12 | 10×16 | 130 | 10 | 10×16 | 120 | 8.2 | 10×16 | 100 |
| 15 | 10×21 | 170 | 12 | 10×21 | 150 | 10 | 10×21 | 130 |
| 18 | 10×25 | 200 | 15 | 10×25 | 180 | 12 | 10×25 | 160 |
| 33 | 13×21 | 290 | 27 | 13×21 | 260 | 22 | 13×21 | 230 |
| 39 | 13×26 | 350 | 33 | 13×26 | 320 | 27 | 13×26 | 280 |
| 47 | 13×31 | 420 | 39 | 13×31 | 380 | 33 | 13×31 | 330 |
| 56 | 16×24 | 460 | 47 | 16×24 | 420 | 56 | 16×32 | 500 |
| 82 | 16×32 | 630 | 68 | 16×32 | 570 | 68 | 16×36 | 580 |
| 100 | 16×36 | 730 | 82 | 16×36 | 660 | 82 | 18×36 | 680 |
| 120 | 18×36 | 860 | 100 | 18×36 | 780 | 100 | 18×41 | 790 |
| 150 | 18×41 | 1020 | 120 | 18×41 | 910 | | | |

■ 耐久性 ENDURANCE

□ 82 μ F-200V 13×26 △ 68 μ F-400V 16×32 ▲ 100 μ F-450V 18×41

