

SH 系列
SERIES

105°C 小型品(L=5,7)
壽命：105°C 2000 小時

105°C MINIATURE SIZE STANDARD
Load Life :105°C 2000 hours

■ 規格表 SPECIFICATIONS

項目 Items	特性 Characteristics								
使用溫度範圍 Category Temperature Range	-40~+105°C								
額定電壓範圍 Rated Voltage Range	6.3~63V.DC								
靜電容量容許差 Capacitance Tolerance	±20%(M)(25°C, 120Hz)								
洩漏電流 Leakage Current (MAX)	I ≤ 0.01CV 或 3 μA (值小於 3 μA 時使用) (施加額定電壓 2 分鐘後) I ≤ 0.01CV or 3 μA whichever is greater (After 2 minutes application of rated voltage) I : 洩漏電流 Leakage Current(μA) C : 額定靜電容量 Rated Capacitance(μF) V : 額定電壓 Rated Voltage(V)								
散逸因素(tan δ) Dissipation Factor (MAX)	額定電壓(V) Rated Voltage	6.3	10	16	25	35	50	63	25°C 120Hz
	tan δ	0.24	0.20	0.17	0.15	0.12	0.12	0.10	
高溫負荷 Load Life	105°C 恆溫施加額定電壓(含紋波電流)2000 小時後，必須滿足下列的值。 After applying rated voltage with rated ripple current for 2000hrs at 105°C, the capacitors shall meet the following requirements.								
	靜電容量變化率 Capacitance Change	初期值±25%以內 Within ±25% of the initial value							
	散逸因素(tan δ) Dissipation Factor	規格值 200%以下 Not more than 200% of the specified value							
	洩漏電流 Leakage Current	規格值以下 Not more than the specified value							
高溫放置 Shelf Life	105°C 恆溫不施加額定電壓 500 小時後，必須滿足下列的值。 After applying no rated voltage for 500hrs at 105°C. The capacitors shall meet the following requirements.								
	靜電容量變化率 Capacitance Change	初期值±20%以內 Within ±20% of the initial value							
	散逸因素(tan δ) Dissipation Factor	規格值 200%以下 Not more than 200% of the specified value							
	洩漏電流 Leakage Current	規格值 200%以下 Not more than 200% of the specified value							
突波電壓(V) Surge Voltage	額定電壓(V) Rated Voltage	6.3	10	16	25	35	50	63	
	突波電壓(V) Surge Voltage	8	13	20	32	44	63	79	
低溫特性 Low Temperature Stability (合成阻抗比) Impedance Ratio (MAX)	額定電壓(V) Rated Voltage	6.3	10	16	25	35	50	63	120Hz
	Z(-25°C) / Z(25°C)	4	3	2	2	2	2	2	
	Z(-40°C) / Z(25°C)	10	8	6	4	3	3	3	

■ 尺寸圖 DIMENSIONS

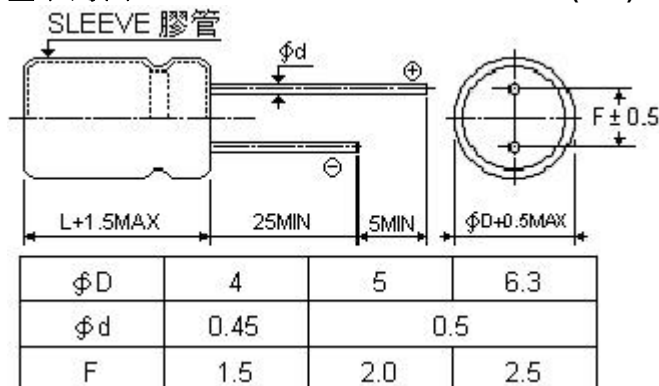

(mm)

■ 紋波電流補償係數 MULTIPLIER FOR RIPPLE CURRENT

(1) 頻率係數 Frequency coefficient

頻率(Hz) Frequency	60(50)	120	1k	≥10k
係數 Coefficient	0.47~47 μF	0.75	1.00	1.30
	100~220 μF	0.75	1.00	1.15

■ 尺寸一覽表，額定紋波電流一覽表 STANDARD SIZE, RATED RIPPLE CURRENT

Size ϕ D \times L(mm), Ripple Current (mA r.m.s./105°C, 120 Hz)

額定電壓 額定 靜電容量 Cap(μ F)	6.3 (0J)		10 (1A)		16 (1C)		25 (1E)		35 (1V)		50 (1H)		63 (1J)	
	Size	Ripple	Size	Ripple	Size	Ripple	Size	Ripple	Size	Ripple	Size	Ripple	Size	Ripple
0.10											4 \times 7	3	4 \times 7	3
0.22											4 \times 7	5	4 \times 7	5
0.33											4 \times 7	6	4 \times 7	6
0.47					4 \times 7	26					4 \times 7	7	4 \times 7	7
1					4 \times 7	26	4 \times 7	28			4 \times 7	11	4 \times 7	11
2.2					4 \times 7	26	4 \times 7	28			4 \times 7	16	4 \times 7	16
											5 \times 7	34		
3.3					4 \times 7	26	4 \times 7	28			4 \times 7	20	5 \times 7	22
4.7					4 \times 7	26	4 \times 7	28	4 \times 7	28	4 \times 7	27	6.3 \times 7	31
10					4 \times 7	26	4 \times 7	28	4 \times 7	28	5 \times 7	34	6.3 \times 7	31
					5 \times 7	55					6.3 \times 7	45		
22	4 \times 7	33	4 \times 7	36	4 \times 7	39	4 \times 7	28	5 \times 7	36				
					5 \times 7	55	5 \times 7	47						
33	4 \times 7	40	4 \times 7	44	4 \times 7	39	6.3 \times 7	65	6.3 \times 7	60				
					5 \times 7	55								
47	5 \times 7	55	5 \times 7	60	6.3 \times 7	75	6.3 \times 7	65	6.3 \times 7	60				
100	5 \times 7	55	5 \times 7	60	6.3 \times 7	110	6.3 \times 7	65						
	6.3 \times 7	90	6.3 \times 7	100										
220	6.3 \times 7	90	6.3 \times 7	100	6.3 \times 7	110								

額定電壓 額定 靜電容量 Cap(μ F)	6.3 (0J)		10 (1A)		16 (1C)		25 (1E)		35 (1V)		50 (1H)	
	Size	Ripple	Size	Ripple	Size	Ripple	Size	Ripple	Size	Ripple	Size	Ripple
0.47											4 \times 5	25
1											4 \times 5	25
2.2											4 \times 5	25
3.3											5 \times 5	26
4.7							4 \times 5	21	4 \times 5	23	6.3 \times 5	35
10					4 \times 5	20	4 \times 5	21	5 \times 5	27	5 \times 5	26
							5 \times 5	35			6.3 \times 5	35
22	4 \times 5	38	4 \times 5	40	4 \times 5	29	5 \times 5	35	6.3 \times 5	45		
					5 \times 5	38	6.3 \times 5	63				
33	4 \times 5	43	4 \times 5	42	5 \times 5	38	6.3 \times 5	63				
47	5 \times 5	45	5 \times 5	45	6.3 \times 5	84	6.3 \times 5	63				
100	5 \times 5	48	6.3 \times 5	75	6.3 \times 5	84						
220	6.3 \times 5	70										

■ 耐久性 ENDURANCE

△ 10 μ F-16V 5 \times 7 ▲ 100 μ F-16V 6.3 \times 7 □ 10 μ F-25V 4 \times 7

